

BALI
CATAMARANS

4.2



Sail in OPEN SPACE

| NAVIGUER EN OPEN SPACE |

CATANAGroup

4.2





Xavier Fay & LASTA®
Design Studio

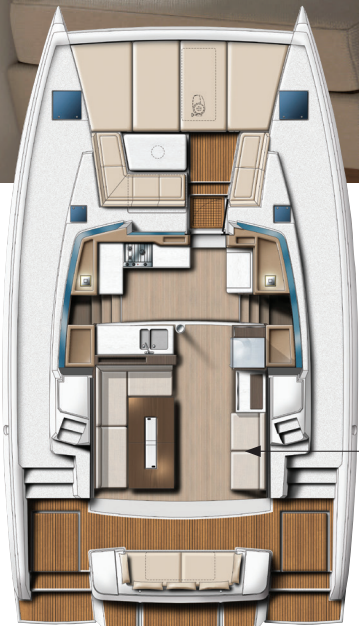

Teak deck Optional



BALI 4.2

O P E N S P A C E



Conception	Olivier PONCIN
Naval Architect / Architecte Naval	Xavier FAÏ
Interior design / Design intérieur	Lasta Design Studio
Overall length / Longueur hors tout	12.85 m / 42.15'
Water line length / Longueur de flottaison	12.46 m / 40.88'
Beam / Largeur	7.08 m / 23.23'
Draft / Tirant d'eau	1.12 m / 3.8'
Light displacement / Déplacement léger	11.5 t approx.
Engines / Motorisation*	2 x 30 hp / cv up to 2 x 45 hp / cv Yanmar

Standard mainsail area / Surface de GV standard	50 m ² / 538 sqft
Code 0 / Code 0*	63 m ² / 678 sqft
Standard self-tacking solent / Solent auto vireur standard	35 m ² / 377 sqft
Fresh water / Eau douce*	860 l / 227 USGal
Fuel*	600 l / 158.5 USGal
Refrigerator / Réfrigérateur*	up to 326 l approx. / 11.51 cu ft
Engines / Motorisation*	2 x 30 hp / cv up to 2 x 45 hp / cv Yanmar
CE Cat	A (Pending / En cours)

* Equipment according to chosen Pack and options - Equipement selon Pack et options choisis

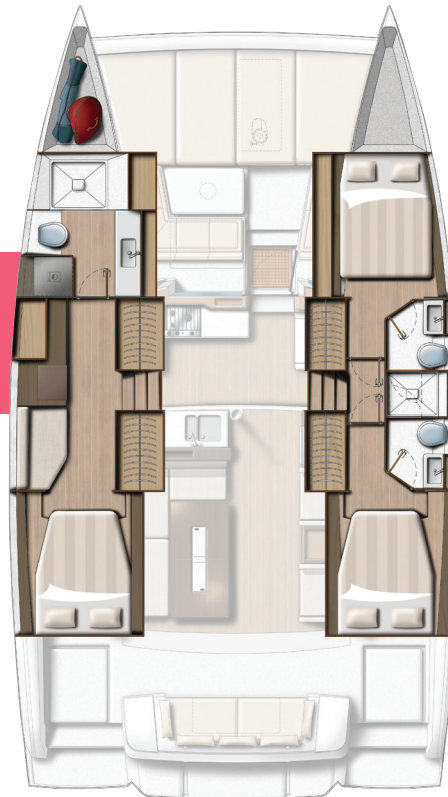

Owner's version 3 cabins and 3 baths
Version propriétaire 3 cabines / 3 sdb

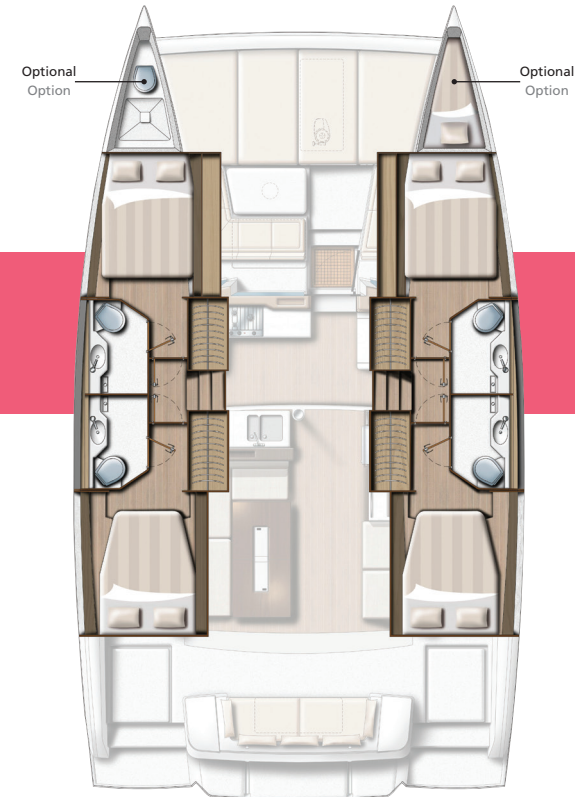

4 cabins and 4 baths symmetric version
Version 4 cabines / 4 sdb symétriques



BALI CATAMARANS - CHANTIER CATANA
ZONE TECHNIQUE DU PORT - 66140 CANET EN ROUSSILLON - FRANCE
info@catanagroup.com www.bali-catamarans.com

